

S 081 1.0S

I. kat

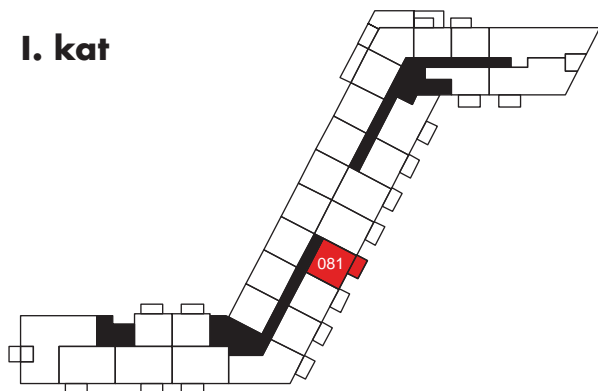

1S			
1	ulaz		3,58 m ²
2	boravak i blagovanje		15,05 m ²
3	kuhinja		3,95 m ²
4	soba		10,21 m ²
5	kupaonica		3,65 m ²
	ukupno		36,44 m²
6	balkon	0,50 x 4,83 m ² =	2,42 m ²
	sveukupno		38,86 m²